

# DIY Doors for Goat Shed

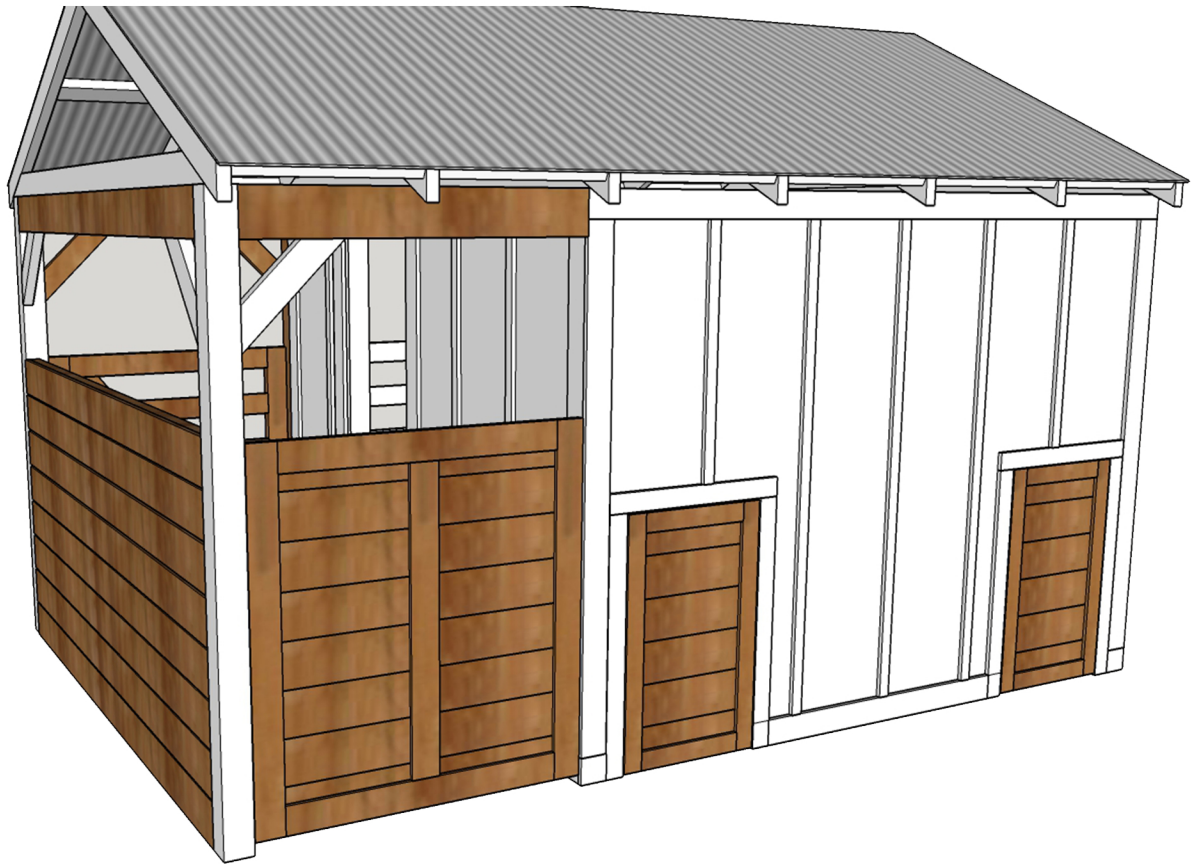

## Materials:

### Small Doors-

-6 - 1x6x6 fence pickets

### Large Door-

-5 - 1x4x6 fence pickets

-4 - 1x6x8 fence pickets

### Barn Door-

-2 - 2x6x8

## Cut List:

### Small Doors-

- 2 - 1x3 (1x6 ripped in half) fence pickets @ 33"

- 2 - 1x3 fence pickets @ 14 7/8"

- 6 - 1x6 fence pickets @ 19 7/8"

### Large Door-

- 2 - 1x4 fence pickets @ 44"

- 2 - 1x4 fence pickets @ 34 3/8"

- 1 - 1x4 fence picket @ 37"

- 8 - 1x6 fence pickets @ 41 3/8"

### Barn Door-

- 2 - 2x3 (2x6 ripped in half) @ 65"

- 1 - 2x3 @ 28"

- 4 - 2x3 @ 23"

## Small Doors:

**Step 1: Build the frame for the small doors. Use pocket holes drilled at  $\frac{5}{8}$ " depth into the ends of the  $14\frac{7}{8}$ " boards. Use 1" screws along with wood glue to attach.**

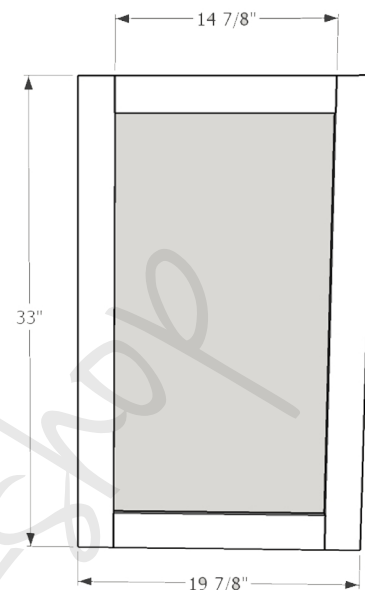

**Step 2: Attach the 1x6 fence pickets to the back of the frame you built in step 1. The boards are cut at  $19\frac{7}{8}"$  and are glued flush with the edges of the frame. Screw through the 1x6s into the frame. Make sure and see the post for any additional help you may need!**

**Seal them and the doors are ready to hang!**

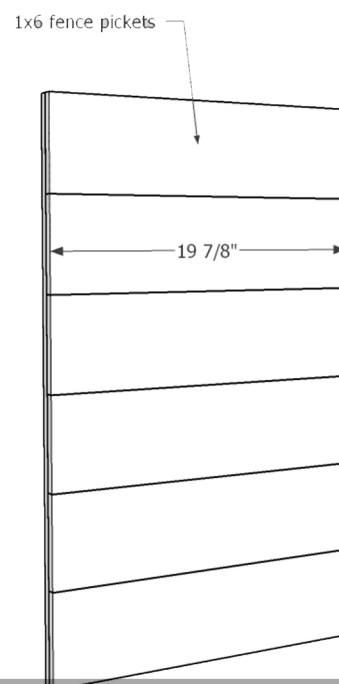

## Large Door:

**Step 1: Build the frame for the large door just as was done with the small doors. Again, use  $\frac{5}{8}$ " pocket holes drilled into the  $34\frac{3}{8}"$  boards. Make sure and use wood glue and 1" screws to attach!**

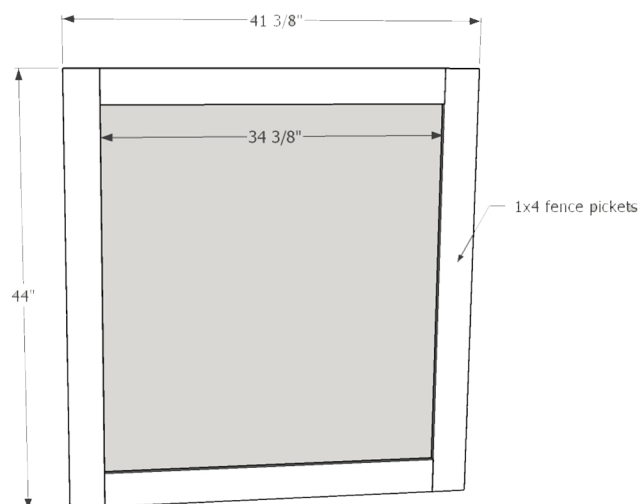

**Step 2: Add the middle brace to the large door. Use 5/8" pocket holes and 1" screws to attach. Make sure and use wood glue on all joints.**

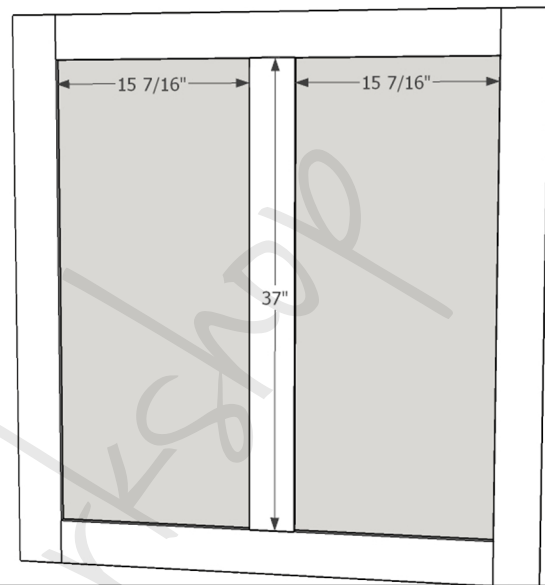

**Step 3: Attach 1x6 fence pickets @ 41 3/8" to the back of the frame built in previous steps. Just glue and screw through the 1x6s into the frame!**

**Large door is ready to be sealed and hung!**

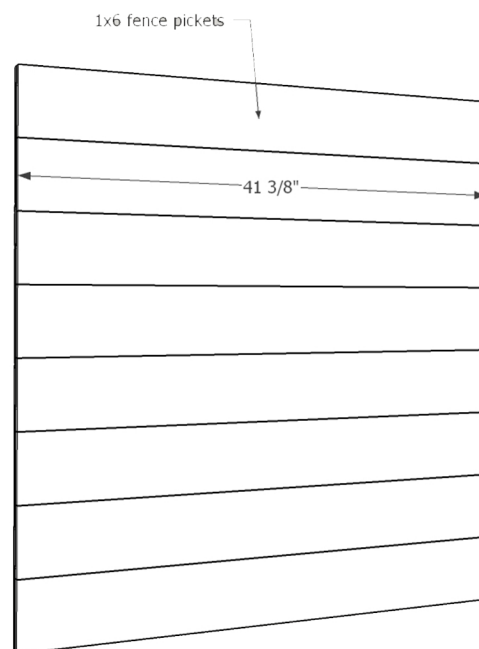

## **Barn Door:**

**Step 1: Build the frame of the barn door from 2x3s which are 2x6s ripped in half! Use pocket holes drilled at 1 1/2" depth and use 2 1/2" screws to attach. Use wood glue on all joints!**

**The barn door is ready to have hardware cloth added and be hung!**

