

DIY Mudroom in an Armoire

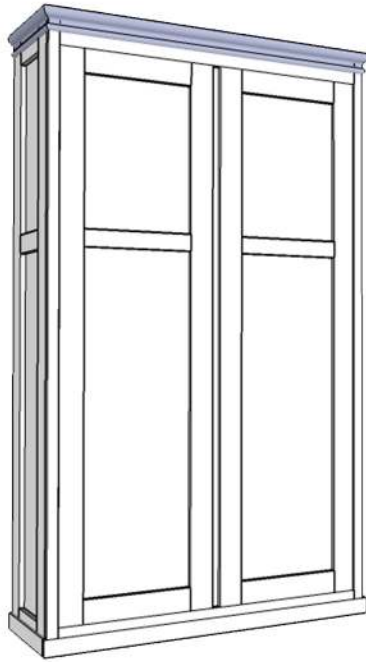

Materials:

- 1 - full sheet 3/4" plywood
- 1 - half sheet 3/4" plywood
- 2 - full sheet 1/4" plywood
- 1 - 1x8x8
- 11 - 1x4x8 (I used furring strips to get the old worn look...but it takes a lot of digging to come by straight ones)
- 2 - 1x3x8 (I used furring strips)
- 4 - 1x2x8 (I used furring strips)
- 1 - stick of crown molding
- Kreg Jig
- Saw
- brad nailer
- 1 1/4" screws
- 1 1/4" brad nails
- wood glue

Cut List:

Make sure that you measure if you don't use furring strips as it will slightly adjust some lengths of boards!! Your plywood should not be affected though!

- 2 - pieces of 3/4" plywood ripped down to 16" x 84"
- 1 - 3/4" piece of plywood ripped down to 16" x 48"
- 1 - 3/4" piece of plywood ripped down to 16" x 46 1/2"
- 2 - 3/4" pieces of plywood ripped down to 14" x 46 1/2"
- 2 - 3/4" pieces of plywood ripped down to 14" x 12"
- 1 - 1/4" piece of plywood ripped down to 84" x 48"
- 2 - 1/4" pieces of plywood ripped down to 18 3/4" x 74 1/4"
- 4 - 1x4 @ 84 3/4"
- 4 - 1x4 @ 8 3/4"
- 4 - 1x4 @ 77 1/4"
- 4 - 1x4 @ 15 3/4"
- 1 - 1x4 @ 76 3/4"
- 2 - 1x4 @ 46 1/2"
- 1 - 1x3 @ 50 1/2"
- 2 - 1x3 @ 16 5/8"
- 2 - 1x3 @ 15 3/4"
- 2 - 1x3 @ 8 3/4"
- 1 - 1x8 @ 46 1/2"
- 2 - 1x2 @ 84 3/4"
- 2 - 1x2 @ 12"
- 2 - 1x2 @ 46 1/2"

Measure for your crown molding!

Step 1:

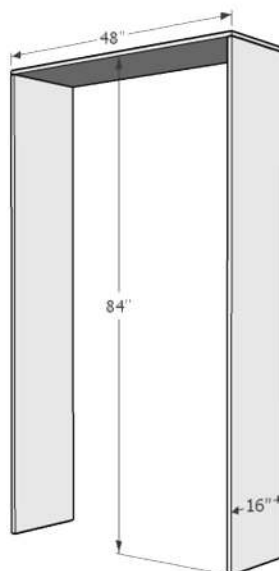

Step 2:

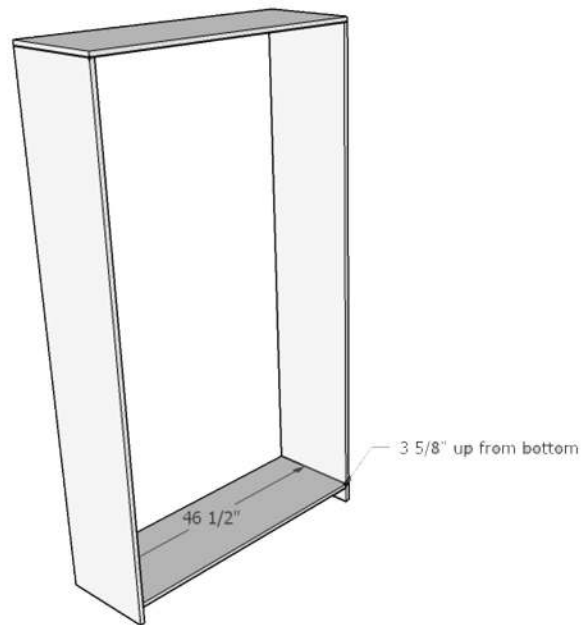

Step 3:

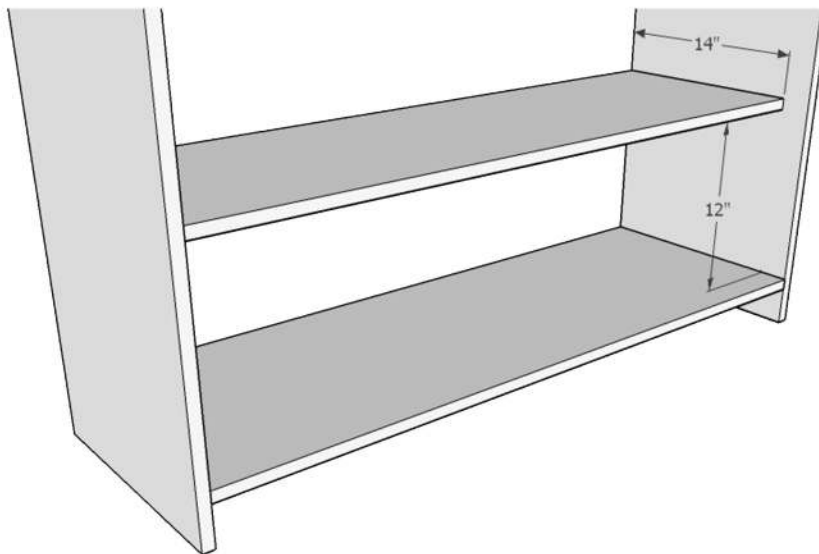

Step 4:

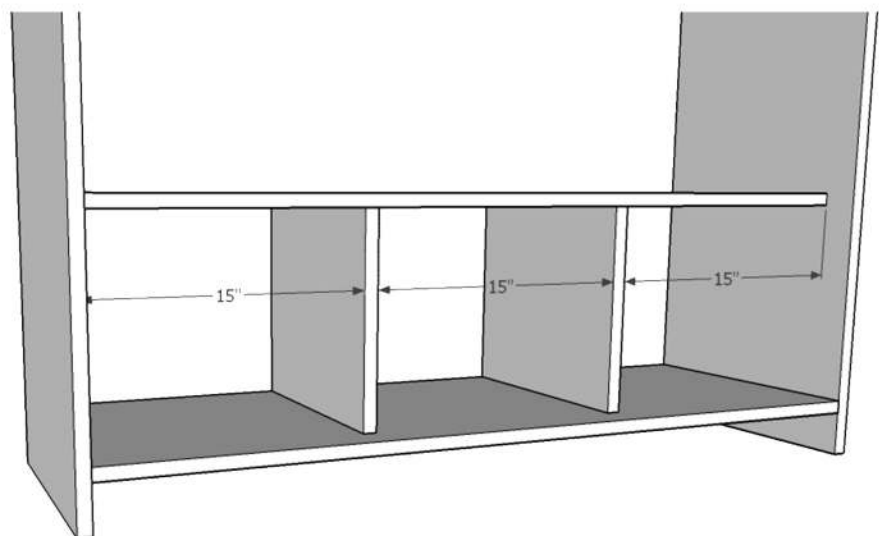

Step 5:

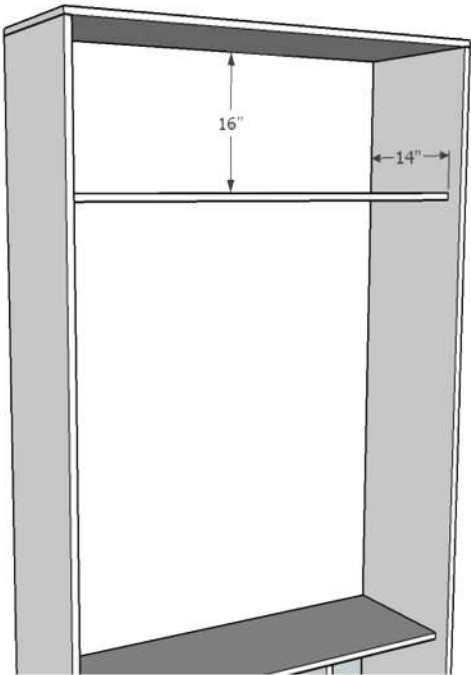

Step 6:

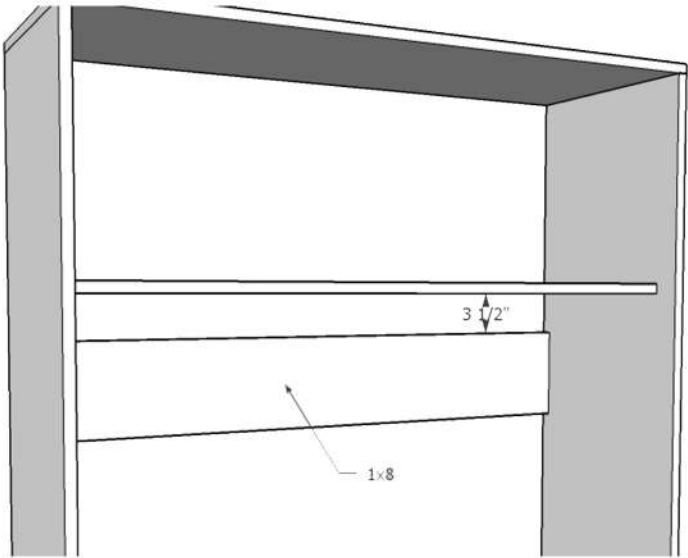

Step 7:

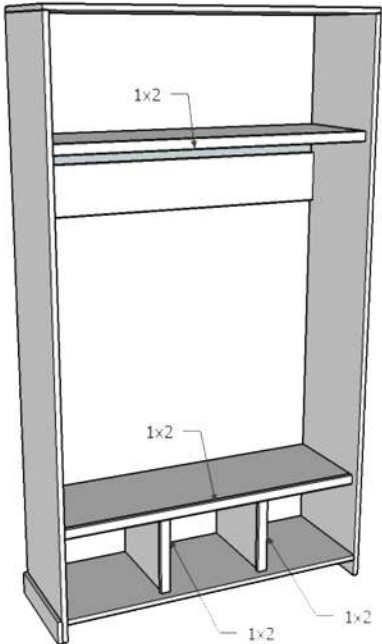

Step 8:

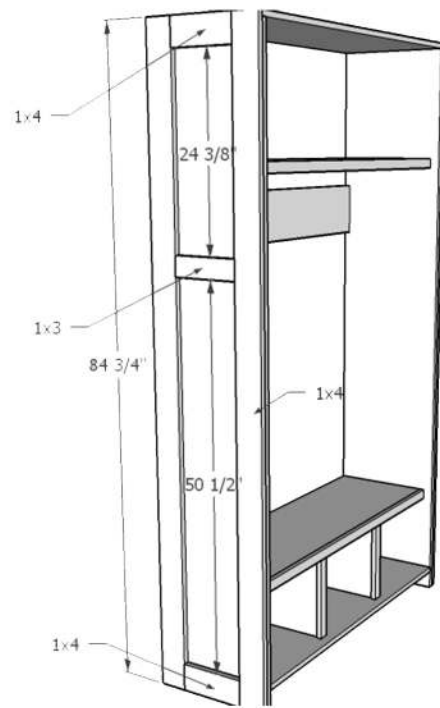

Step 9:

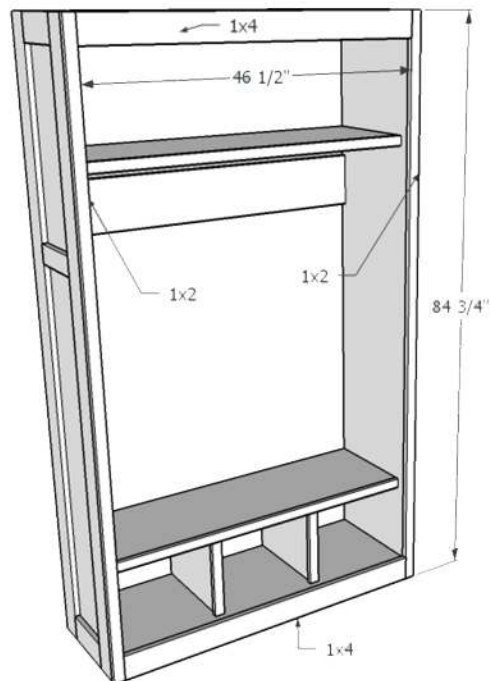

Step 10:

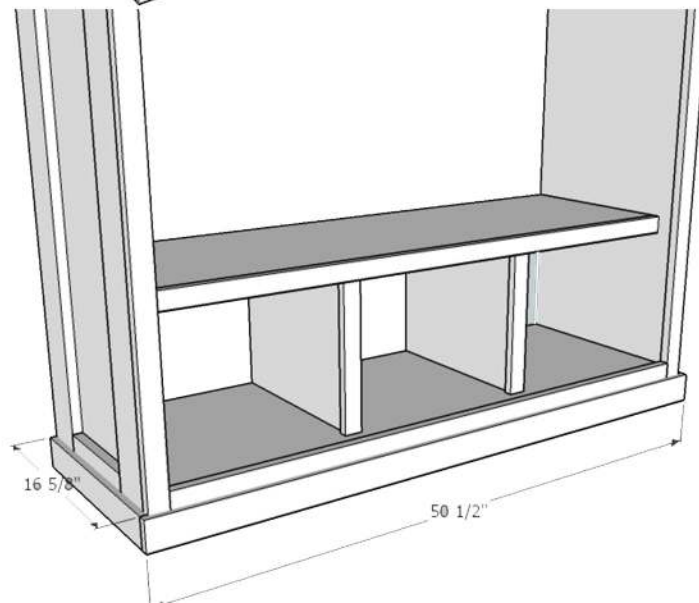

Step 11:

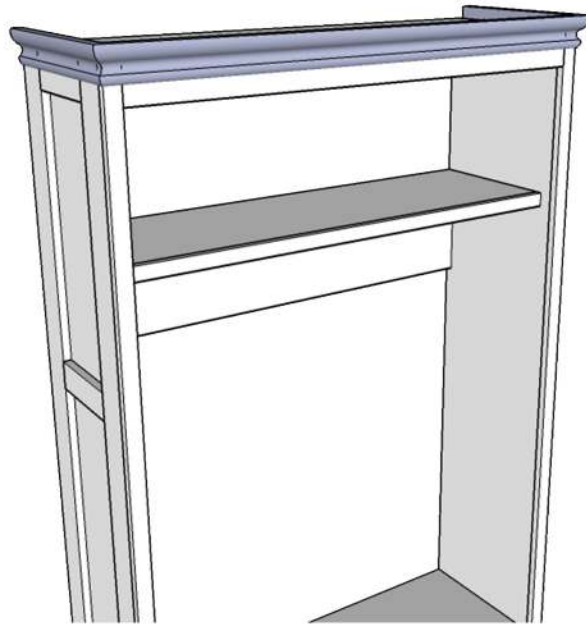

Step 12:

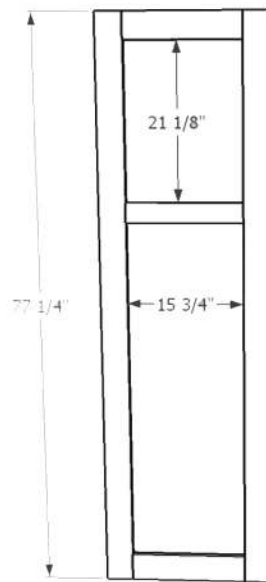

Step 13:

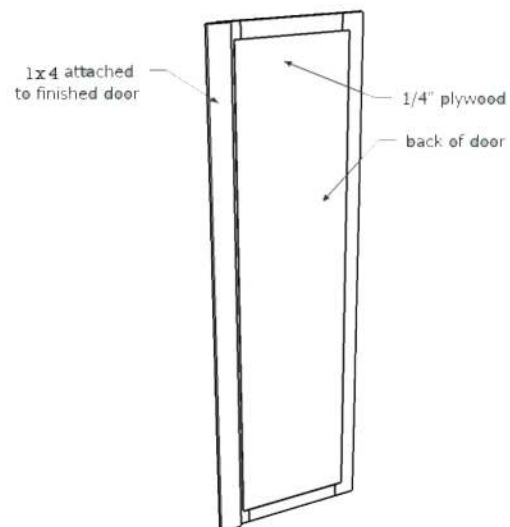

Step 14:

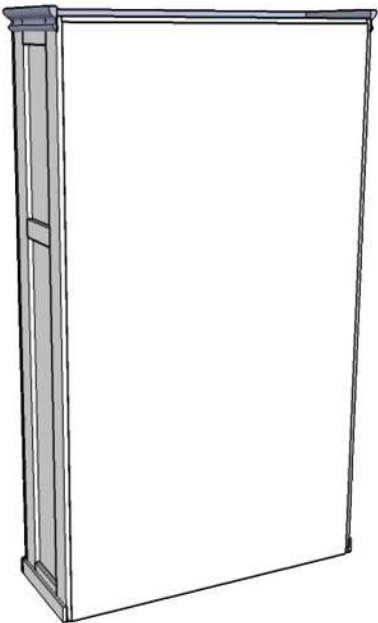

DONE!!

